

Levelling System Details

GENERAL

The Profloor Levelling System was developed in order that a level finished floor could be laid on a cambered, stepped or uneven subfloor.

The system will contribute towards meeting the statutory impact and airborne requirements of the Building Regulations depending on the subfloor construction.

The Profloor Levelling System complements the Profloor Dynamic Batten System which is used on broadly flat and level subfloors to provide impact sound insulation for party floors between flats and apartments. Profloor Levelling Bases are also used for any building which requires a level finished floor to be laid on an uneven subfloor.

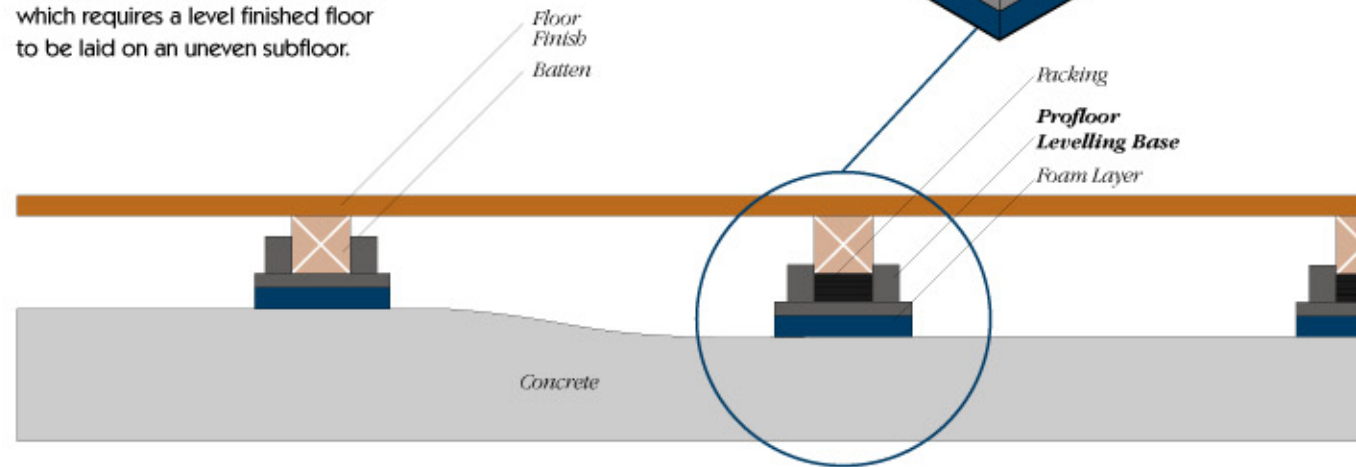

WHY USE PROFLOOR LEVELLING SYSTEM?

Profloor Levelling Bases provide impact sound insulation so can be used on party floors in flats and apartments with a concrete subfloor of not less than 300 kg/m².

The system can be used on other build-ups. Please contact the APG Techline for specific advice.

Profloor plastic packers inserted in each base allow the battens supporting the chipboard or other surface material to be adjusted for level. Thus the Profloor Levelling System can be laid level on out-of-level and uneven subfloors.

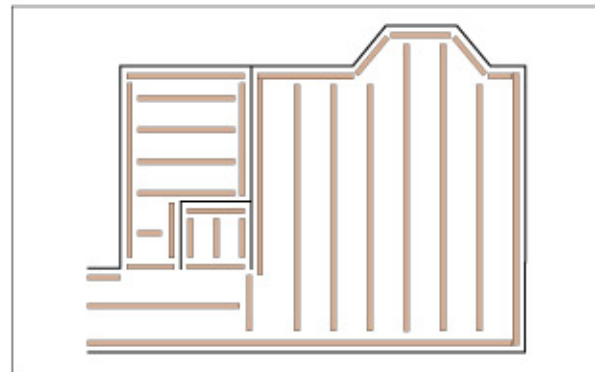

Fig 1. Layout of battens for the Profloor Levelling System

Laying Procedure

Levelling base centres and all fixing to be strictly in accordance with these Laying Procedures.

1. Laying to a Datum

The floor should be laid level to a datum marked in each area by inserting packing pieces in each levelling base to level the battens before the boards are laid.

Care must be taken before laying commences to ensure that there is sufficient depth to accommodate the flooring system without packing when placed on the highest point of the area.

2. Spacing of Bases

Profloor bases are placed on the subfloor at appropriate centres according to the thickness of battens and to the spacing of battens for the flooring boards to be used:

Recommended spacing between levelling bases, along the length of the batten.

- 21mm thickness battens - 300 mm centres.
- 33mm thickness battens - 450 mm centres.
- 45 mm thickness battens - 600 mm centres.

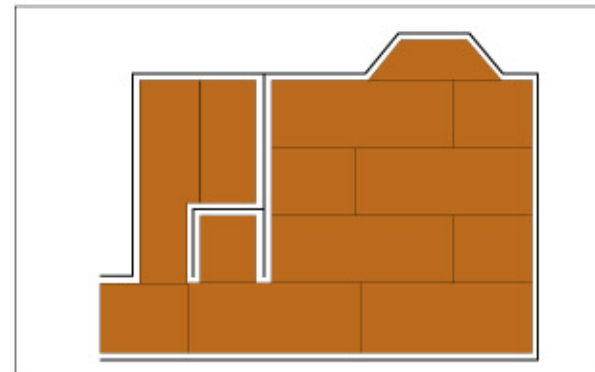

Fig 2. Layout of boarding for the Profloor Levelling System

3. Spacing of Battens

Spacing for domestic use within dwellings.
18 mm C4 chipboard - batten centres maximum 450 mm.
22 mm C4 chipboard - batten centres maximum 600 mm.
Spacing should be reduced for areas where heavier loading is anticipated. Spacing for plywood is according to manufacturer's recommendations.

4. Layout

Place bases parallel with all walls around each room keeping a minimum 15 mm from all walls. Bases are positioned lengthways under battens except where a batten at right angles requires support. The base is then rotated 90° so that the right angled batten rests on the packing inserted in the base.

At corners one base supports the ends of both battens where they meet and the ends of battens in line are always supported on a base.

5. Levelling Bases

Having laid out the bases, position the laser levelling staff on the base and place packers under it until the required reading is obtained.

6. Packers

Profloor packer depths of 5mm, 3mm or 2mm must be used for fine adjustment. Packers do not need to be glued.

7. Battens

Having placed packers in each base, place battens between the base upstands and ensure the battens are stable and level before applying **Profloor Adhesive** to the top - not required with hardwood strip flooring.

8. Flanking Strip

Profloor Flanking Strip minimum 100mm wide x 5mm thick is placed around each wall protruding above the floor surface at least 50mm - see Fig 8

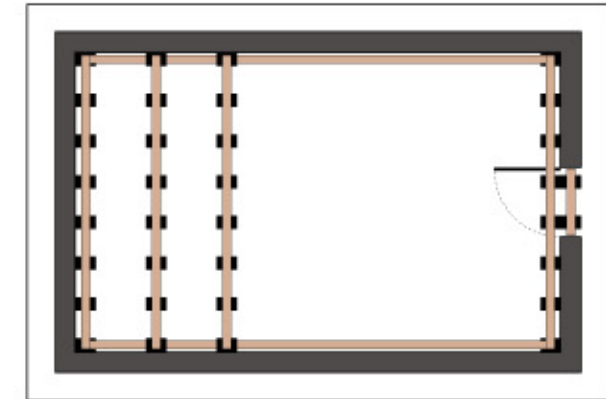

Fig 3. Levelling bases and battens

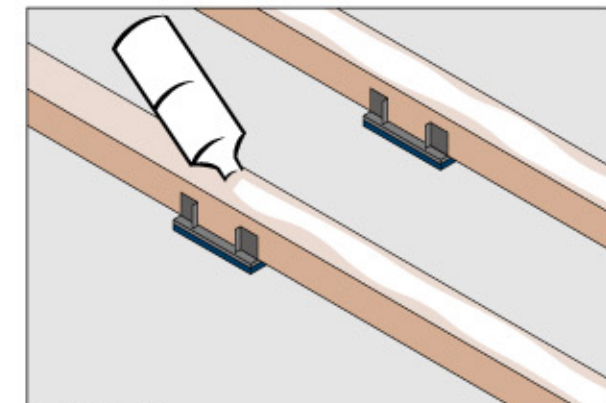

Fig 4. Gluing battens

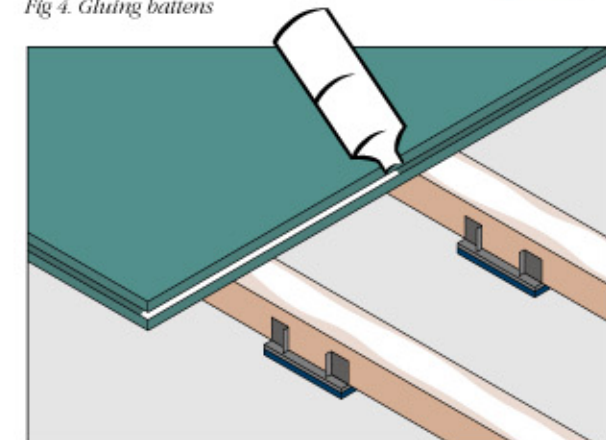

Fig 5. Gluing joints

Laying Procedure

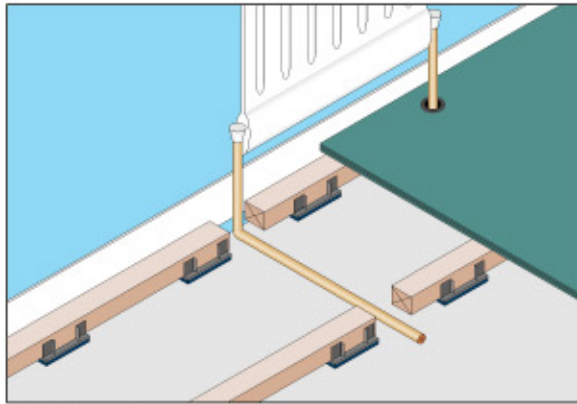

Fig 6. Services

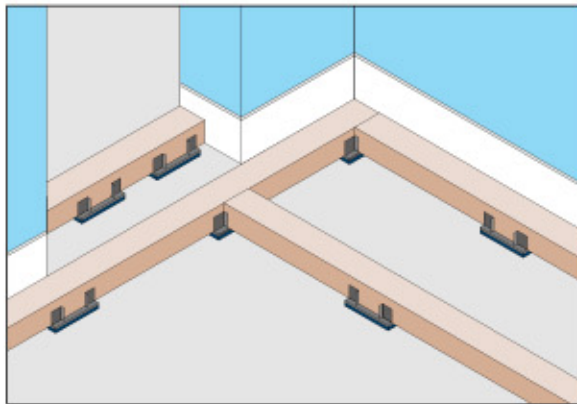

Fig 7. Doorways

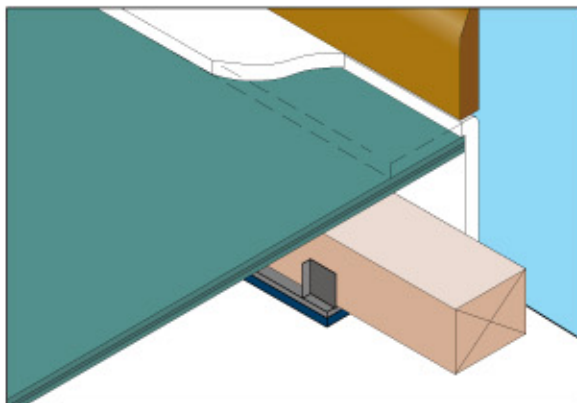

Fig 8. Skirting

9. Fixing Boarding

The boards should be fixed in accordance with BS8201:1987, using annular ringed-shank nails or screws at 300mm intervals along the batten. Care must be taken not to penetrate any services crossing the line of battens. We would additionally recommend the use of adhesive to glue the boards to the battens.

The T & G joints of all boards should be glued using Profloor PVA Adhesive or similar.

10. Expansion

A minimum gap of 10mm should be left between the boarding and all walls to BS 8201 1987.

In larger areas with uninterrupted lengths of floor such as corridors, expansion gaps must be inserted across the area at appropriate intervals in accordance with the floor board manufacturer's recommendations.

11. Board Ends

Where these fall between battens, place a short length of batten supported by two bases under the joint.

12. Services

Where services cross the subfloor, these may run under the battens subject to sufficient depth, i.e a minimum of 5mm should be left between the underside of the batten and any service pipes.

Where battens need to be cut to allow pipework to cross, leave a gap of 15 mm either side. The position of bases may have to be altered to accommodate services but spacing should not be increased.

13. Doorways

Where boards are butted together in doorways a batten must be placed across supported by bases so that the board joints meet on a batten.

14. Skirting Boards

Fold the Profloor Flanking Strip down over the edge of the floor and fix the skirting so it rests on the flanking strip. Trim off surplus flanking strip flush with the face of the skirting board.

15. Protection

To prevent damage by following trades the finished floor should be covered by a protective layer immediately after installation.

16. Mounting Partitions

It is generally recommended that partitions are erected off the sub-floor, but where non loadbearing partitions are to be built off the finished floor, an additional two lines of battens on bases should be placed under the line of the partition.

17. Ceramic Tiling

Where there is a requirement for ceramic tiling above the Profloor Levelling System, please refer to the adhesive and grout manufacturer, the tile manufacturer and The A Proctor group.

TYPES OF BASE

Levelling bases are manufactured from injection moulded High Grade Polymer, size 70 x 100mm in three types:

L, M and H, with 10mm (uncompressed) foam bonded to the base. Type **H** is for deeper floors with the foam bonded to softwood inserts of different thickness, which fit under the levelling base.

Type L -requires 21mm thickness battens
-floor depth minimum 51mm up to 67mm.

Type M -requires 33mm, 45mm or thicker battens.
-floor depth minimum 63mm up to 91mm
with 33mm battens
-floor depth minimum 75mm up to 103mm
with 45mm battens

Type H -requires 45 mm or thicker battens.
-floor depth minimum 95mm up to 203mm
with packing

(All above floor depths allow for 18mm boarding supplied by others).

Accessories

Profloor Adhesive

This is for gluing the tongue and groove joint of chipboard or plywood - packers fitted into each base do not require to be glued.

Fixings

Annular ringed-shank nails and adhesive or screws should be used to fix boarding to the battens in accordance with the board manufacturer's laying instructions. 38 mm fixings will be needed for 21mm thick battens and minimum 2.5 times the thickness of the flooring for larger batten sizes. Care must be taken not to penetrate through the batten with the fixings.

Flanking Strip

Profloor Flanking Strip 10metres x 100mm (min) x 5mm thick should be laid vertically around the walls of each room so as to protrude above finished floor level.

When fitting the skirting board it is compressed by the bottom edge and the surplus can then be trimmed.

Continuous product development is a fundamental principal of The A. Proctor Group Ltd, and to this end the Specification may be enhanced without further notice.



The Haugh, Blairgowrie, Perthshire, PH10 7ER

Telephone (01250) 872261

Facsimile (01250) 872727

E-Mail: insulation@proctorgroup.com

www.proctorgroup.com

TECHLINE ADVICE SERVICE

01250 872261

MADE IN  BRITAIN

apg5602

PRODUCED BY RUSH JAMES DESIGN - 01785 716644

PROFLOOR LEVELLING SYSTEM

user guide

..the knowledge to produce solutions



www.proctorgroup.com