

PROFLOOR RESILIENT BATTEN

DESCRIPTION

The Profloor Resilient Batten System from the A. Proctor Group comprises a dressed softwood timber batten, with an integral closed cell resilient layer.

KEY FEATURES

- Economical product
- For use with concrete subfloors only
- Ideal where a service run is required
- Complies with Part E of the building regulations (Section 5 in Scotland)
- Certified for use with relevant Robust Detail floor constructions (tested in accordance with RD Appendix D)

ADVANTAGES

- Single Batten for use in - main floor area, perimeters, kitchens and bathrooms
- Quality kiln dried timber
- High performance resilient layer - 10mm
- Can be used with Robust Standard Detail floor construction types E-FC- 1, E-FC-2, E-FC-7 and E-FS-1 (steel floor)
- Suitable for use beneath lightweight internal partitions
- Ideal for pre-cast, cast in-situ and beam & block floors
- Technical support from specification through to site from our Regional Sales Managers throughout the UK
- Specialist technical advice either online at www.proctorgroup.com or directly from the dedicated technical advisors on our tech-line 01250 872 261
- Products readily available through a national network of distribution partners

PHYSICAL PROPERTIES

Standard Sizes:

43mm x 45mm x 3600mm length

55mm x 45mm x 3600mm length

69mm x 45mm x 3600mm length

Flanking Strip:

100mm wide x 5mm thick (10m rolls)

125mm wide x 5mm thick (10m rolls)

150mm wide x 5mm thick (10m rolls)

Alternative batten sizes available to order.

ROBUST DETAILS

FFT 3

Resilient composite batten system

Suitable for use on the following RD floors:

- E-FC-1
- E-FC-2
- E-FC-7
- E-FS-1

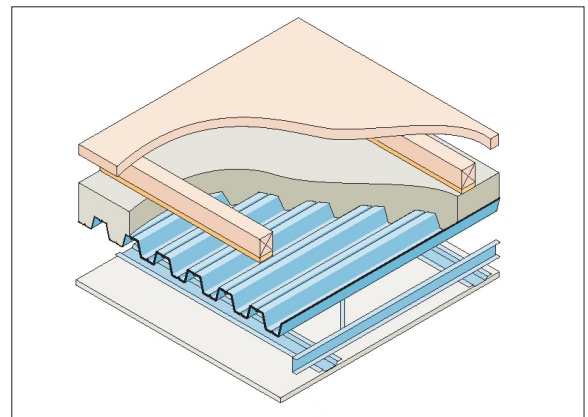

E-FS-1 Floor

ADDITIONAL PRODUCTS



www.proctorgroup.com

The Haugh, Blairgowrie, Perthshire, PH10 7ER

Tel: +44 (0) 1250 872 261 Fax: +44 (0) 1250 872 727 email: ask@proctorgroup.com



PROFLOOR RESILIENT BATTEN

Design Details and Installation

Sub-floor

Profloor Resilient Batten is only suitable for use on concrete sub floors. The sub-floor must be dry and swept clean, generally level and the surface should be such that Profloor Resilient Batten can be laid flat.

Commencement of laying

All windows should be installed and glazed, wet trades completed and sufficient time allowed for thorough drying out.

Laying procedure

The Profloor Resilient Batten System should be laid in accordance with BS 8201:1987.

Perimeter battens

Place a single row of Profloor Resilient Batten around floor perimeter maintaining 50mm gap between wall and batten. (See figure 1.)

Spacing of battens

Batten spacing to be in accordance with flooring manufacturer's recommendations - Commonly:
400mm centres (450mm max) for 18mm chipboard and 600mm centres (max) for 22mm chipboard.

Mounting partitions

Where non load-bearing partitions are to be mounted on the finished floor, install a double row of Profloor Resilient Battens along the line of the partition (See figure 2). Particular care must be taken in the batten layout. Alternatively, use short lengths of Profloor Resilient Battens as noggins between adjacent battens, at centres to suit flooring board thickness, to create a "ladder" under the partition line (see figure 3). Partitions can also be taken off the sub-floor - for example, to minimise the effect of any camber (see figure 4).

Fixing flooring

Apply Profloor Adhesive to the tongue and groove joints of all flooring boards. Fix as normal using screws (preferably) or annular ringed shank nails ensuring resilient layer is not penetrated.

Expansion of flooring materials

Allow expansion gap between the free edge of the floor boards and the perimeter wall or other abutment. This gap should be 1mm per linear metre of flooring and a minimum of 10mm. (See figure 1)

Services within flooring system

Services can be accommodated in the batten cavity. Care should be taken to ensure the services can be accommodated within the compressed batten cavity without coming into contact with underside of the flooring.

Kitchen/bathroom and other areas of increased loading

When the floor loading is in excess of 1.5kN/m², Profloor Resilient Batten should be installed with spacing closed to 300mm centres (maximum). It is also recommended that hallways, both internal and common, be treated in the same manner to accommodate the combination of high foot traffic and small floor areas.

Accessories

Profloor Water Resistant Adhesive

This is used for gluing the tongue and groove joint of chipboard or plywood and for bonding flooring to the battens.

Physical Properties

High solid content PVA adhesive

Size: 1 litre bottle

Profloor Flanking Strip

This must be installed around the perimeter of each floor to prevent flanking transmission.

Size: 5mm x 150mm x 10m (other widths available).

Technical Advice

If any Technical advice is required, at either the design or installation stage, please contact the Technical Department of The A. Proctor Group Ltd.

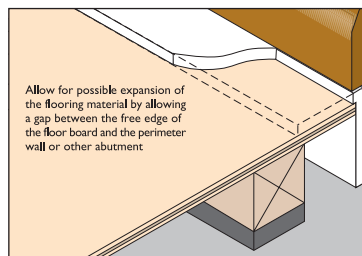

figure 1

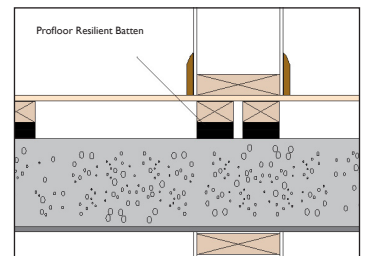

figure 2

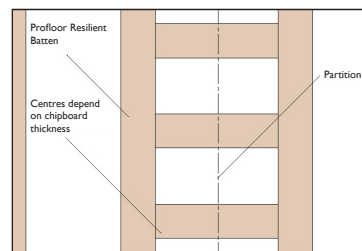

figure 3

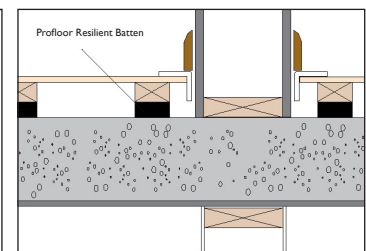

figure 4